



Ford Road, London, E3

BUTLER & STAG



Guide Price £500,000 - £550,000
Welcome to Dethick Court, this architecturally designed three/four bedroom duplex maisonette redefines modern living, offering a unique blend of style, space, and comfort, providing you the perfect home.



Leasehold

- Duplex Maisonette
- West Facing Balcony
- Modern Bathroom
- Open Plan Living Concept
- Victoria Park A Moments Walk Away
- 887 Sq/Ft Internal Living Space
- Three/Four Bedrooms
- 125 Year Lease
- Chain Free
- Mile End Tube Station Close By

Located in the vibrant neighbourhood of Bow, Dethick Court enjoys a prime location with easy access to an array of amenities and attractions. Just moments away from the award winning Victoria Park, an eclectic mix of shops, cafes, and restaurants that line the streets of Roman Road, or take a leisurely stroll along the nearby Regent's Canal.

Step into your new home and be greeted by a bright and airy living space, characterized by high ceilings, modern finishes, and stylish decor. The social flow of the main living seamlessly connects to the dining, and kitchen areas, creating an inviting space perfect for both relaxing and entertaining.

The kitchen is lined with jet black handleless flat face design cabinetry, concrete countertops, copper splash backs and ample storage space, making meal preparation a pleasure.

The maisonette features three/four spacious bedrooms spread across two levels, offering privacy and flexibility for you.

Dethick Court is within striking distance of the award winning Victoria Park one of east London's most spacious alfresco-eating spots, with two lakes, a boating pond, playgrounds, and a scattering of other Instagram-worthy delights. Excellent transport links are nearby, including several bus routes into the City, whilst Mile End (Central, District and Hammersmith & City) and Bow Road (District and Hammersmith & City) are just about equidistant from the property.





Dethick Court

Approx. Gross Internal Area 82.4 sq. metres (887.1 sq. feet)

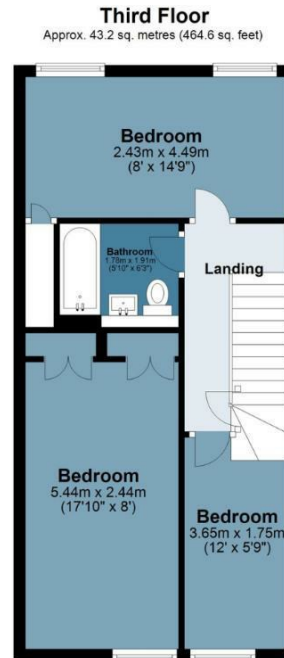

Measurements are approximate and for illustration purposes only. While we do not doubt the accuracy and completeness, we advise you conduct a careful independent assessment of the property to determine monetary value
© @modephotouk www.modephoto.co.uk



☎ 020 8102 1236

🏠 508 Roman Road, Bow, London, E3 5LU

✉ bow@butlerandstag.com

IMPORTANT NOTICE - These particulars have been prepared in good faith and they are not intended to constitute part of an offer or contract. We have not performed a structural survey on this property and the services, appliances and specific fittings have not been tested. All photographs, measurements, floor plans and distances referred to are given as a guide and should not be relied upon.

www.butlerandstag.uk